

# NEW!



## ALHX65 is now available!

A LARGER DN65 PUMP TO ENHANCE ALBIN PUMP ALH PORTFOLIO

Albin Pump has expanded its product offering by adding the ALHX65 pump to its portfolio. The ALHX65 is recommended for applications requiring flow rates between 8 to 17 m<sup>3</sup>/h (35-75 gpm).

### THE ALHX65 INTEGRATES THE FAMILIAR ADVANTAGES OF THE ALH PORTFOLIO:

- ✓ Improved total cost of ownership relative to competition
- ✓ Close coupled mounting that eliminates internal bearings
- ✓ Quick, yet user-friendly maintenance
- ✓ Competitive pricing
- ✓ Simple, robust and reliable pump design
- ✓ Low shear stress that results in a longer hose life

### TARGET MARKETS



Mining & Quarries



Ceramic



Waste Water Treatment



Processing Chemicals

### APPLICATION EXAMPLES

- ✓ Lime Milk – Lime Slurry
- ✓ Sludge removal
- ✓ Filter press feeding
- ✓ Thickener underflow
- ✓ Well dewatering
- ✓ Truck/Tank unloading

#### Crescent-shaped window

- Allows easy access for shimming without the need to drain lubricant - while maintaining cover rigidity.

#### Welded frame

- Increased stiffness while ensuring a lighter-weight design.

#### Drain valve

- Allows for easy lubricant removal when required

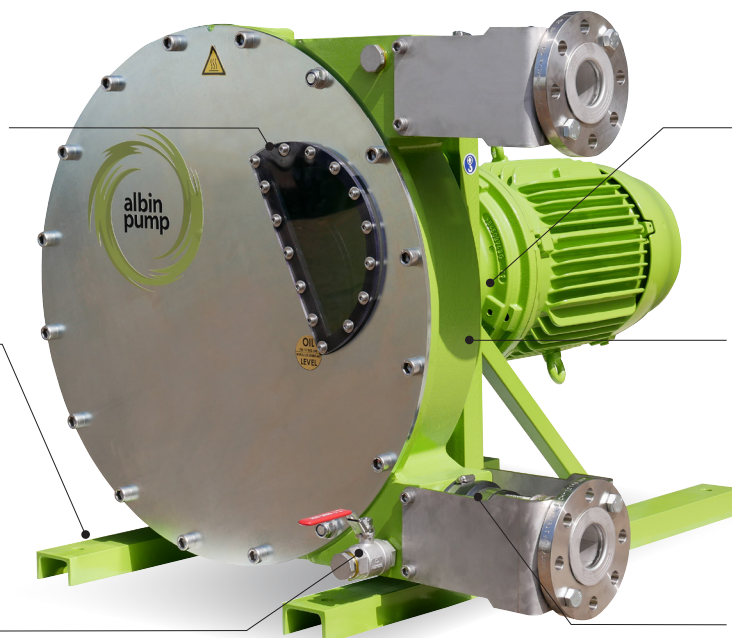

#### Casing, wheel and shoes

- The high quality GS400 ductile iron components provide improved mechanical strength and impact resistance.

#### C4 paint

- This highly resistant coating is suitable for heavy duty and corrosive environments.

#### Connections and fittings

- Industrial grade clamps increase reliability and ease of maintenance.



www.albinpump.com  
albinpump@irco.com  
©2021 Ingersoll Rand IRITS-0821-027 EN 1121





# ALHX65

## Data Sheet

Note: For latest version of datasheet please refer to [albinpump.com](http://albinpump.com)

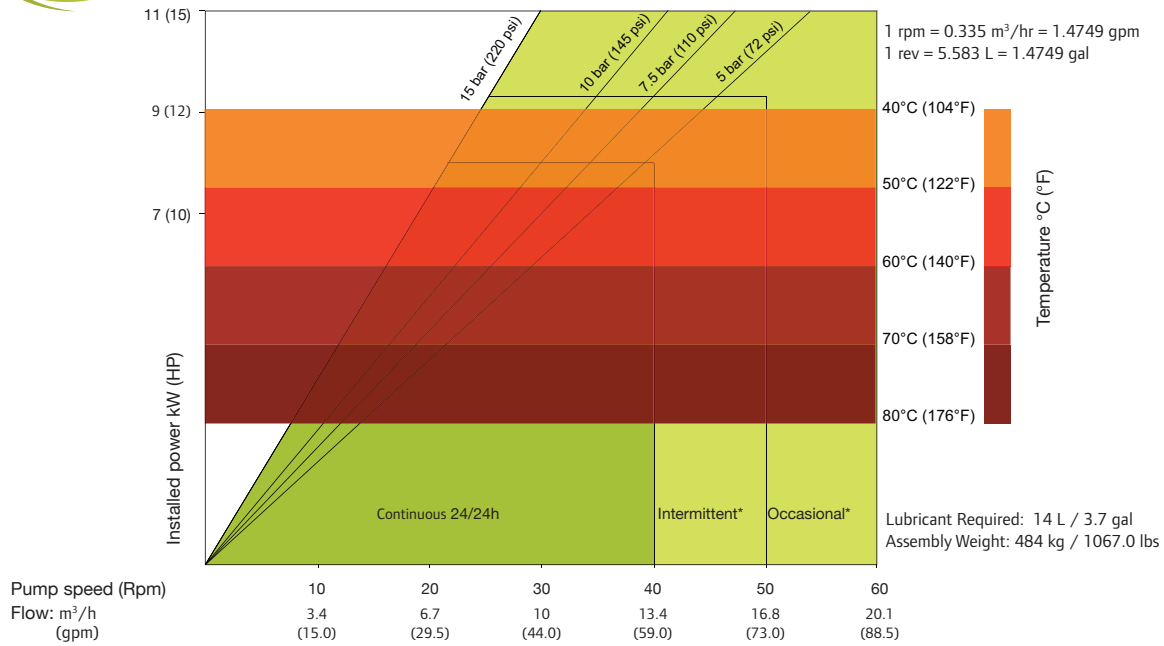

\*Intermittent use : minimum one hour stop after 2 hours run / \*Occasional use : maximum one hour a day

SHOE SHIMMING TABLE - ALHX65

Pressure bar (psi)	Speed - Rpm	Number of shims* - thickness 0.5 mm (0.019 in)
$\Delta P \leq 5$ (72.5)	0 to 25	0
	25 to 65	0
5 (72.5) $\leq \Delta P \leq 7.5$ (108.75)	0 to 25	2
	25 to 46	1
7.5 (108.75) $\leq \Delta P \leq 10$ (145)	0 to 25	3
	25 to 40	2
10 (145) $\leq \Delta P \leq 15$ (217.5)	0 to 25	4
	25 to 31	3

\*Remove one shim if temperature exceeds 60° Celsius (140° Fahrenheit)

## DIMENSIONS

mm (Inch)

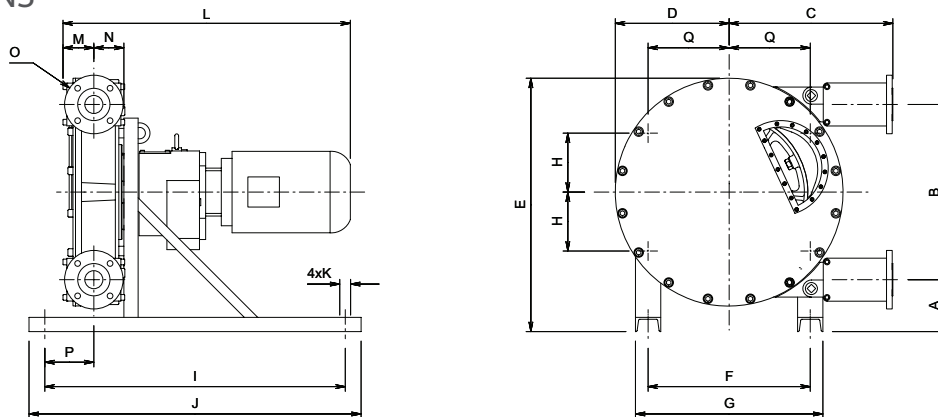

TYPE	A	B	C	D	E	F	G	H	I	J	K	L	M	N	O	P	Q
ALHX65	143 (5.6)	597 (23.5)	598 (23.5)	390 (15.3)	831 (32.7)	513 (20.1)	593 (23.3)	186 (7.3)	950 (37.4)	1050 (41.3)	4xø19 (4xø0.7)	-	113 (4.4)	113 (4.4)	DN65 PN16 ANSI 2.5 in / 150#	136 (5.3)	256 (10.0)

Albin Pump is a brand of Ingersoll Rand and part of the Precision and Science Technologies (PST) business segment. PST consists of a portfolio of complementary technologies and industry leading brands such as Milton Roy®, ARO®, LMI®, Haskel®, Thomas®, Dosatron®, SEEPEX®, MP Pumps® and Oberdorfer®. At PST, we deliver solutions for precision dosing and transfer of high value fluids in mission-critical markets such as life sciences, food and beverage, water and hydrogen. For more information, visit [www.IRCO.com](http://www.IRCO.com).